

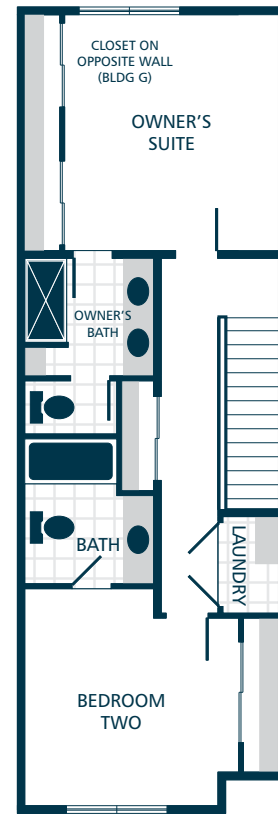

INTERIOR UNIT

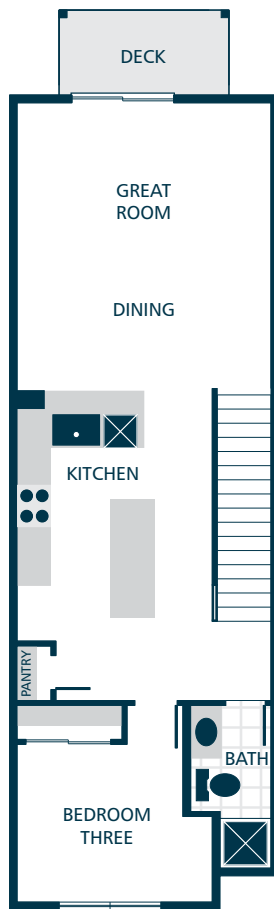
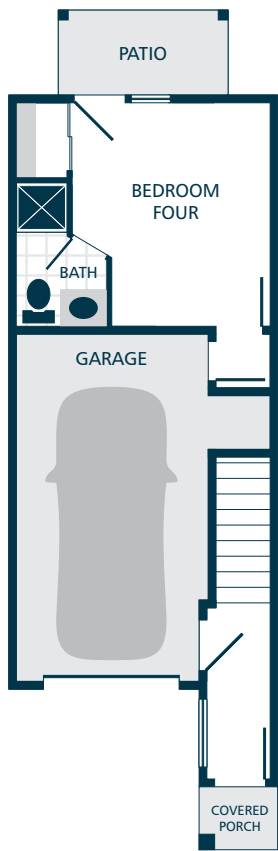

KITCHENS

- QUARTZ SLAB COUNTERTOPS WITH STATEMENT TILE BACKSPLASH
- SHAKER STYLE CABINETS WITH CROWN MOULDING
- EFFICIENT, STAINLESS STEEL DISHWASHER, MICROWAVE, & PREMIUM SLIDE IN ELECTRIC RANGE
- GOURMET HOOD VENT & CONVENIENT POT-FILLER
- GORGEOUS LAMINATE HARDWOOD FLOORING
- STYLISH PENDANT LIGHT ACCENTS

LIVING SPACES

- GORGEOUS LAMINATE HARDWOOD FLOORING AT KITCHEN, DINING, & GREAT ROOM
- CONTEMPORARY OPEN RAILING ACCENTS
- WHITE PAINTED MILLWORK & ELEGANT WRAPPED WINDOWS
- TWO PANEL DOORS WITH BRUSHED NICKEL HARDWARE
- FOLDING COUNTER IN LAUNDRY

BATHS

- QUARTZ SLAB COUNTERTOPS, DOUBLE SINKS, TILE FLOORING, TILE SHOWER, & DUAL SHOWERHEAD SYSTEM IN OWNER'S SUITE
- QUARTZ SLAB COUNTERTOPS WITH TILE BACKSPLASH ON BATHROOM VANITIES
- LUXURY VINYL TILE FLOORING IN BATHROOMS (EXCLUDES OWNER'S SUITE & MAIN FLOOR BATHROOM)
- SHOWER & TILE FLOORING IN MAIN FLOOR BATHROOM (SELECT HOMES)

EXTERIORS

- PROFESSIONAL LANDSCAPING
- DECK & PATIO W/SYNTHETIC GRASS ACCENTS
- HIGH QUALITY FIBER CEMENT SIDING
- 30 YEAR ARCHITECTURAL COMPOSITION SHINGLES

EVERYDAY DETAILS

- DUCTLESS MINI SPLITS WITH SUPPLEMENTAL ELECTRIC WALL HEAT
- HIGH EFFICIENCY, HEAT PUMP WATER HEATER

UPGRADE OPTIONS

UPGRADE AVAILABILITY IS NOT GUARANTEED.
PRICING IS SUBJECT TO CHANGE WITHOUT NOTICE.

- ELECTRIC FIREPLACE IN GREAT ROOM **\$6,000**
- LAMINATE HARDWOOD FLOORING ON STAIRWAY **\$8,500**
LOWER FLOOR STAIRWAY ONLY
- TILE ACCENT WALL IN MAIN FLOOR BATHROOM **\$2,500**
END UNITS ONLY
- CUSTOM CLOSET SYSTEM IN OWNER'S SUITE **\$TBD**
PRICE VARIES PER HOMESITE
- FRENCH DOOR REFRIGERATOR **\$3,700**
STAINLESS STEEL
- STACKED WASHER WITH DRYER **\$2,800**
- WHITE FAUX WOOD PRIVACY BLINDS **\$TBD**
PRICE VARIES PER HOMESITE
- GARAGE DOOR OPENER WITH REMOTE **\$1,000**
WIFI ENABLED
- EXTERIOR KEYPAD FOR GARAGE DOOR OPENER **\$150**
- 6' CEDAR FENCE WITH GATE **\$TBD**
PRICE VARIES PER HOMESITE

