

MAIN FLOOR

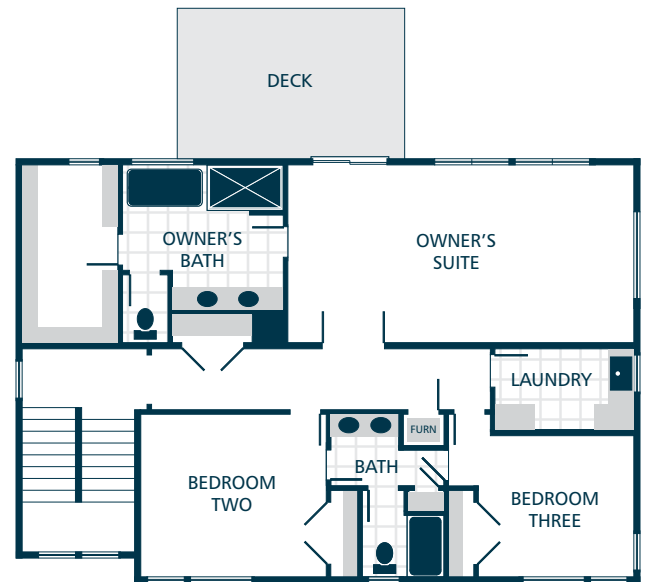

UPPER FLOOR

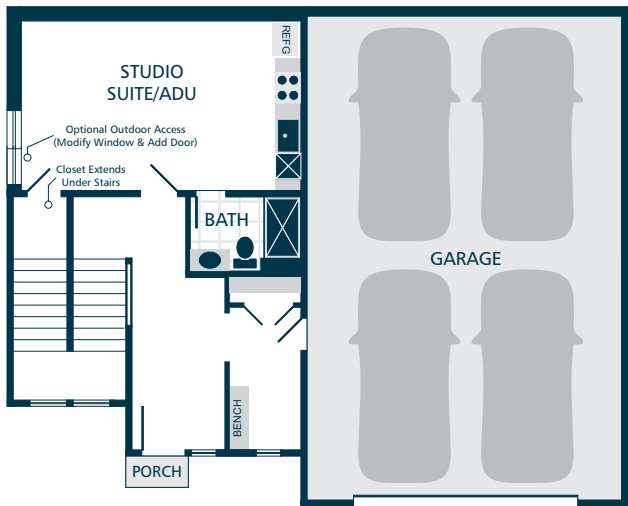

LOWER FLOOR

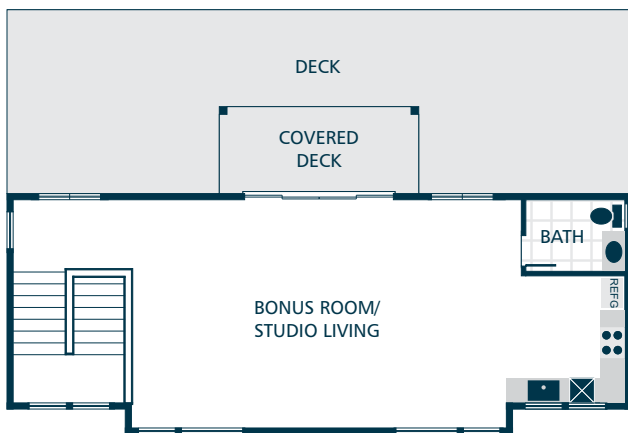

ROOFTOP



KITCHENS

- QUARTZ SLAB COUNTERTOPS WITH STATEMENT TILE BACKSPLASH
- FULL HEIGHT, SHAKER STYLE CABINETS WITH CROWN MOULDING
- HIGH END, STAINLESS STEEL DISHWASHER, BUILT IN MICROWAVE, & FRENCH DOOR REFRIGERATOR
- GOURMET HOOD VENT & 6 BURNER SLIDE IN GAS RANGE
- CONVENIENT POT FILLER (SELECT HOMES)
- STAINLESS STEEL DISHWASHER, BUILT IN MICROWAVE, REFRIGERATOR, & ELECTRIC RANGE (STUDIO/ADU KITCHENS)
- GORGEOUS ENGINEERED HARDWOOD FLOORING

LIVING SPACES

- GORGEOUS ENGINEERED HARDWOOD FLOORING AT KITCHENS, DINING, & GREAT ROOM
- GAS FIREPLACE WITH QUARTZ SURROUND
- CONTEMPORARY OPEN RAILING ACCENTS
- CONVENIENT SERVING STATION IN DINING (SELECT HOMES)
- BUILT IN BENCH/DROP ZONE (SELECT HOMES)
- LUXURY VINYL TILE FLOORING, UTILITY SINK, & FOLDING COUNTER IN LAUNDRY
- STUDIO SUITE/ADU - FULL KITCHEN, LIVING SPACE, & BATHROOM

EVERYDAY DETAILS

- HEAT PUMP FOR COOLING/HEATING
- PREMIUM, TANKLESS HOT WATER HEATER

BATHS

- DOUBLE SINKS, TILE FLOORING, TILE SHOWER, & DUAL SHOWERHEAD SYSTEM IN OWNER'S SUITE
- RELAXING LOUNGE TUB IN OWNER'S SUITE (SELECT HOMES)
- DOUBLE SINKS, TILE FLOORING, TILE SHOWER, DUAL SHOWERHEAD SYSTEM, & LOUNGE TUB IN GUEST BATHROOM (SELECT HOMES)
- QUARTZ SLAB COUNTERTOPS WITH TILE BACKSPLASH ON BATHROOM VANITIES
- LUXURY VINYL TILE FLOORING (EXCLUDES OWNER'S SUITE, GUEST BATHROOM, & MAIN FLOOR BATHROOM)

EXTERIORS

- PROFESSIONAL LANDSCAPING
- FULLY FENCED BACKYARD
- TIMELESS STONE ACCENTS
- STAINED PINE ACCENTS (SELECT HOMES)
- COVERED DECK/DECKS
- HIGH QUALITY FIBER CEMENT SIDING
- 30 YEAR ARCHITECTURAL COMPOSITION SHINGLES

UPGRADE OPTIONS

UPGRADE AVAILABILITY IS NOT GUARANTEED.
PRICING IS SUBJECT TO CHANGE WITHOUT NOTICE.

- PLEASE CONTACT LISTING AGENT FOR UPGRADE REQUESTS

