

MAIN FLOOR

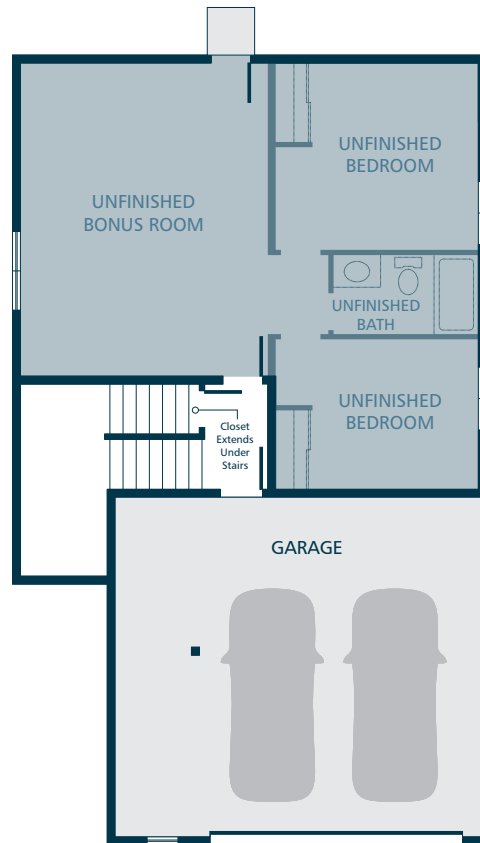

LOWER FLOOR



## KITCHENS

- TIMELESS LAMINATE COUNTERTOPS WITH BEAUTIFUL 4" TILE BACKSPLASH
- TRADITIONAL STYLE CABINETS WITH CROWN MOULDING
- EFFICIENT, BLACK DISHWASHER, HOOD FAN, & ELECTRIC RANGE
- GORGEOUS LAMINATE HARDWOOD FLOORING

## LIVING SPACES

- GORGEOUS LAMINATE HARDWOOD FLOORING AT ENTRY, KITCHEN, & DINING
- WHITE PAINTED MILLWORK & 5 PANEL DOORS
- DURABLE VINYL FLOORING IN LAUNDRY (FINISHED LAUNDRY ONLY)
- STAIN RESISTANT CARPET THROUGHOUT

## EXTERIORS

- PROFESSIONAL FRONT YARD LANDSCAPING
- PATIO AND/OR DECK
- STEEL GARAGE DOORS
- LIMITED LIFETIME WARRANTED CERTAINTeED VINYL SIDING (HOMES UNDER 1,500 FINISHED SQFT)
- 50 YEAR WARRANTED FIBER CEMENT SIDING (HOMES OVER 1,500 FINISHED SQFT)
- 30 YEAR ARCHITECTURAL COMPOSITION SHINGLES

## BATHS

- LAMINATE COUNTERTOPS WITH TILE BACKSPLASH ON BATHROOM VANITIES & DURABLE VINYL FLOORING
- DOUBLE SINKS IN OWNER'S BATHROOM (SELECT HOMES)

## EVERYDAY DETAILS

- DUCTLESS MINI SPLIT WITH SUPPLEMENTAL ELECTRIC WALL HEAT (HOMES UNDER 1,500 FINISHED SQFT)
- EFFICIENT HEAT PUMP FOR COOLING/HEATING (HOMES OVER 1,500 FINISHED SQFT)
- 40 GAL. ELECTRIC WATER HEATER

## UPGRADE OPTIONS

UPGRADE AVAILABILITY IS NOT GUARANTEED. PRICING IS SUBJECT TO CHANGE WITHOUT NOTICE.

- GARAGE DOOR OPENER WITH REMOTE \$800  
WIFI ENABLED
- EXTERIOR KEYPAD FOR GARAGE DOOR OPENER \$150
- 6' CEDAR FENCE WITH GATE \$TBD  
PRICE VARIES PER HOMESITE DIMENSIONS
- WHITE FAUX WOOD PRIVACY BLINDS \$TBD  
PRICE VARIES PER HOMESITE
- SIDE BY SIDE REFRIGERATOR \$2,800  
STAINLESS STEEL
- TOP LOAD WASHER WITH DRYER \$2,500

### BUILDER'S CHOICE PLATINUM PACKAGE

### PREMIUM BUILDER INCLUSIONS INSTALLED ON ALL HOMES

SUBJECT TO CHANGE. SEE LISTING AGENT FOR DETAILS.

- ✓ QUARTZ SLAB COUNTERTOPS IN KITCHEN
- ✓ STAINLESS STEEL APPLIANCES
- ✓ BUILT IN MICROWAVE HOOD FAN & GARBAGE DISPOSAL IN KITCHEN
- ✓ LAMINATE HARDWOOD FLOORING IN GREAT ROOM
- ✓ BACKYARD LANDSCAPING

