

CENTENNIAL TOWNHOMES

THE IVY // DESIGN B

4  | 3.5  | 2  | 1,979 



INTERIOR UNIT

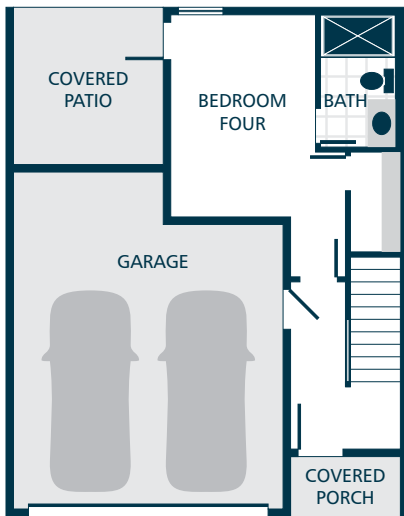

LOWER

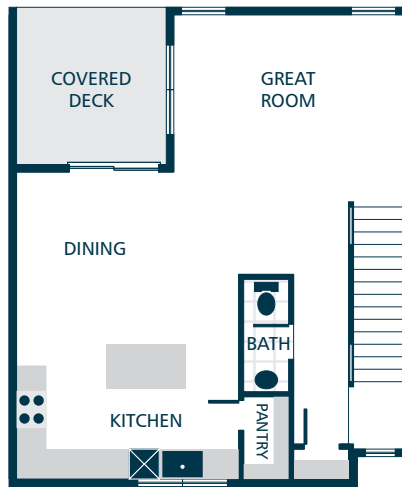

MAIN

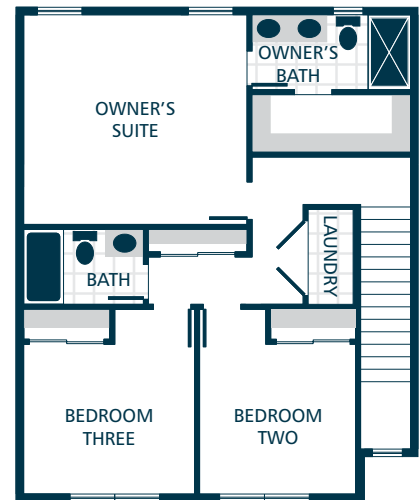

UPPER



KITCHENS

- QUARTZ SLAB COUNTERTOPS WITH MODERN TILE BACKSPLASH
- SHAKER STYLE CABINETS WITH CROWN MOULDING
- STAINLESS STEEL DISHWASHER, BUILT IN MICROWAVE & PREMIUM SLIDE IN ELECTRIC RANGE
- GORGEOUS ENGINEERED HARDWOOD FLOORING
- STYLISH PENDANT LIGHT ACCENTS

LIVING SPACES

- GORGEOUS ENGINEERED HARDWOOD FLOORING IN KITCHEN, DINING, & GREAT ROOM
- WHITE PAINTED MILLWORK WITH BLACK HARDWARE
- CONTEMPORARY OPEN RAILING ACCENTS
- LUXURY VINYL TILE FLOORING IN LAUNDRY

BATHS

- QUARTZ SLAB COUNTERTOPS, DOUBLE SINKS, TILE FLOORING & TILE SHOWER IN OWNER'S SUITE
- QUARTZ SLAB COUNTERTOPS WITH TILE BACKSPLASH ON BATHROOM VANITIES
- TILE FLOORING IN MAIN FLOOR BATHROOM
- LUXURY VINYL TILE FLOORING IN BATHROOMS (EXCLUDES OWNER'S SUITE & MAIN FLOOR BATHROOM)

EXTERIORS

- PROFESSIONAL LANDSCAPING
- STAINED PINE ACCENTS
- COVERED PATIO AND DECK
- 50 YEAR WARRANTED FIBER CEMENT SIDING
- 30 YEAR ARCHITECTURAL COMPOSITION SHINGLES

EVERYDAY DETAILS

- DUCTLESS MINI SPLITS WITH SUPPLEMENTAL ELECTRIC WALL HEAT
- HIGH EFFICIENCY, HEAT PUMP WATER HEATER

UPGRADE OPTIONS

UPGRADE AVAILABILITY IS NOT GUARANTEED. PRICING IS SUBJECT TO CHANGE WITHOUT NOTICE.

- GARAGE DOOR OPENER WITH REMOTE \$800
WIFI ENABLED
- EXTERIOR KEYPAD FOR GARAGE DOOR OPENER \$150
- 6' CEDAR FENCE \$TBD
PRICE VARIES PER HOMESITE DIMENSIONS
- WHITE FAUX WOOD PRIVACY BLINDS \$TBD
PRICE VARIES PER HOMESITE
- SIDE BY SIDE REFRIGERATOR \$2,800
STAINLESS STEEL
- TOP LOAD WASHER WITH DRYER \$2,500

